

ECLIPSE[®]

S H U T T E R S

French Door Cut-Out Template

Cut here for placement.

Place edge against
baseplate of handle.

1

Align/Tape Here

Align/Tape Here

2

Align this line with center of baseplate or centerline between handle and deadbolt.

Cut here for placement.

3

Check handle clearance by rotating door handle. Handle must rotate within this arc.
(See page back for additional details)

This line indicates the hidden edge of the frame.

Confirm fit and placement of frame next to molding and #1 alignment with baseplate.

4

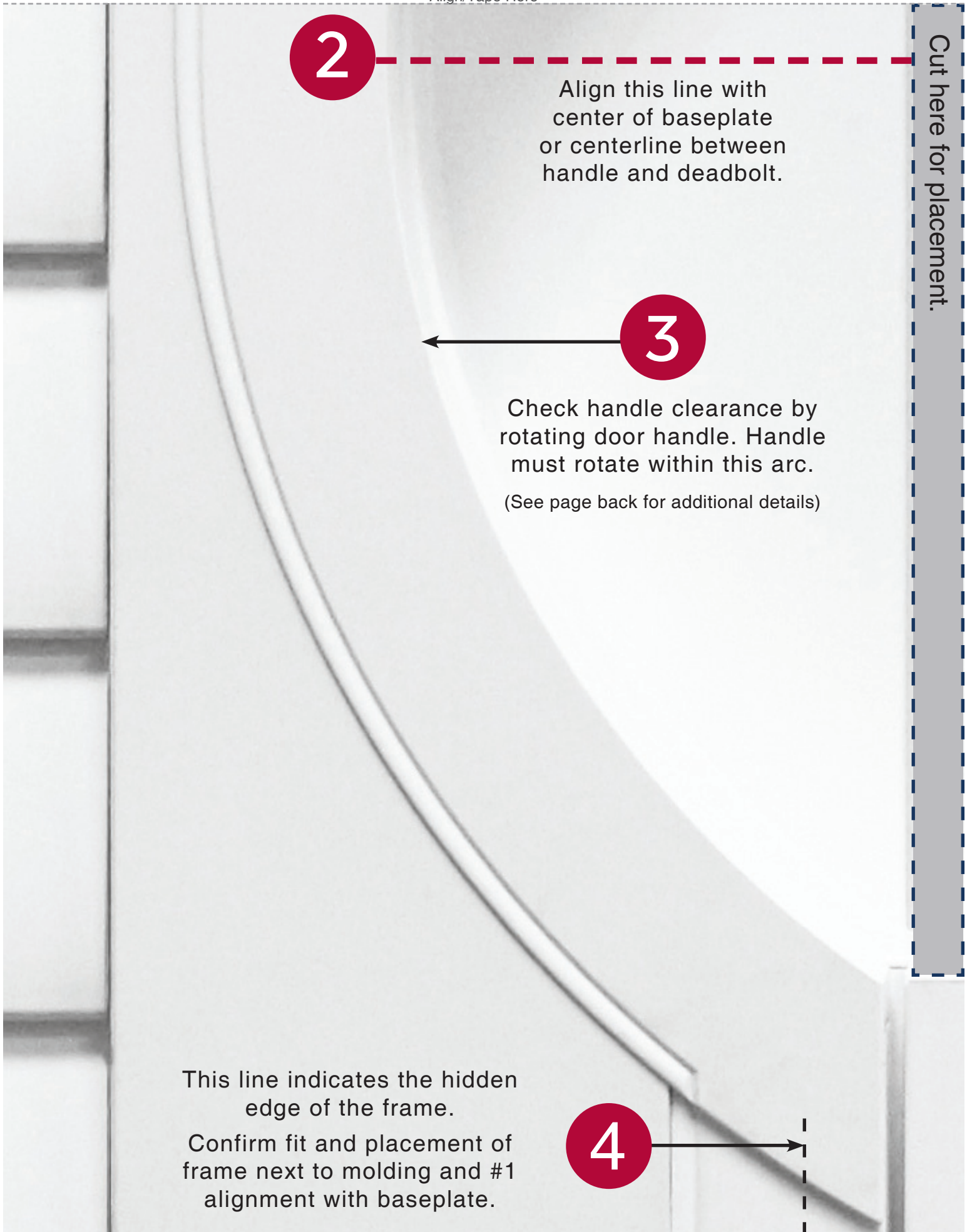

French Door Cut-Out Specifications

	2 ½ inch	3 ½ inch	4 ½ inch
Minimum Width:	18 in	18 in	18 in
Maximum Width:	36 in	36 in	36 in
Minimum Height:	36 in	38 in	40 in
Maximum Height:	96 in	96 in	96 in
Maximum Square Feet:	15 in	15 in	15 in
Minimum Cut-Out Height	17 ¾ in	18 ¾ in	19 ¾ in

OM Depth Clearance (Extensions Required)

L Frame (no molding around glass)	2 ½ inch	3 ½ inch	4 ½ inch
Tilt Bar	0	1	2
UltraClear View	1	2	3
UltraClose Gear	0	1	2

L Frame (with molding around glass)	2 ½ inch	3 ½ inch	4 ½ inch
Tilt Bar	1	2	3
UltraClear View	2	3	4
UltraClose Gear	1	2	3

Features & Benefits

- Available with 4-sided L Frame only
- Available in all louver sizes
- Increased cut-out size to allow for larger handles and deadbolts
- Plate integrated into shutter frame
- Divider rail available (centered on cut-out body)