

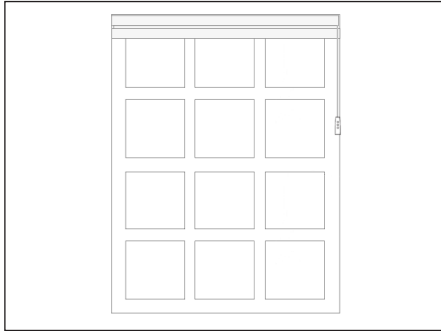

PowerWand™

Quick Start Guide



1. Mount the shade.

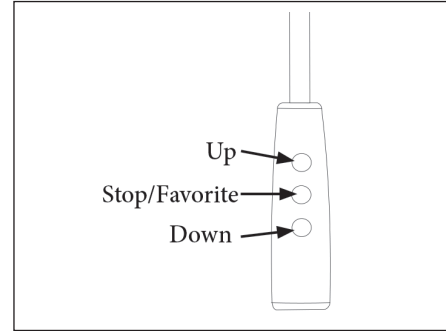

2. Your shade is now ready!

For operation, press the UP or DOWN button on the wand to move the shade in short steps. Hold the UP or DOWN button for two seconds, then release. The shade will travel to its programmed upper or lower limit. Using the center STOP button will allow you to stop the shade at any point during its' travel.

Setting/Using a Favorite Position

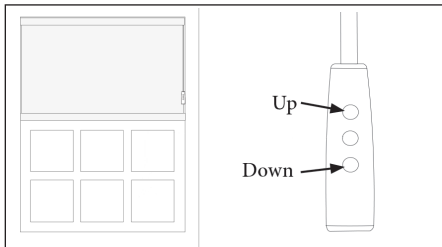

1. Using the UP and DOWN arrows, move the shade to the desired Favorite position.

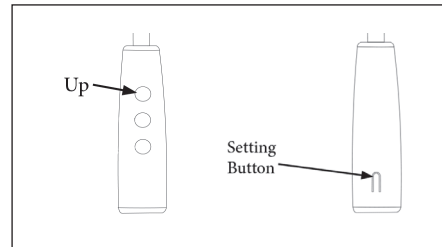

2. To save the Favorite position, hold the SETTING button and hold the UP button at the same time. Release after a series of short beeps.

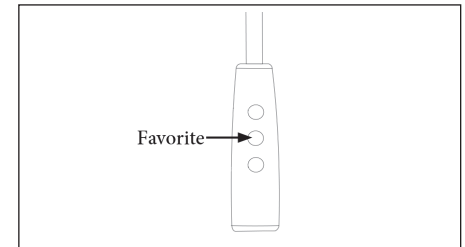

3. Press the STOP/FAVORITE button to move the shade to the set Favorite position.
NOTE: Make sure shade is fully stopped before using the Favorite position.

Adjusting Upper and Lower Limits

The upper and lower limits have been set at the factory.

NOTE: Clearing the factory limits requires both the upper and lower limits to be reset.

ADJUSTING LOWER LIMIT

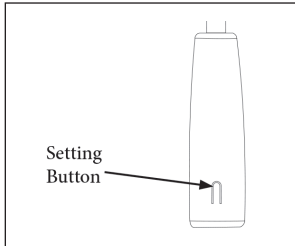

1. Hold the SETTING button until the shade beeps 4 times; about 5 seconds. Release.

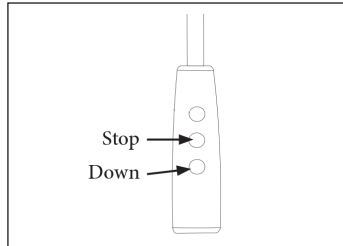

2. After the shade stops beeping, use the DOWN button to lower the shade. Press STOP when the shade is near the desired lower limit.

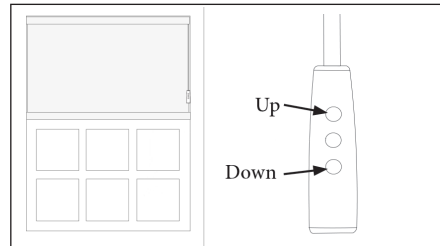

3. Use the UP and DOWN buttons to adjust the lower limit more accurately.

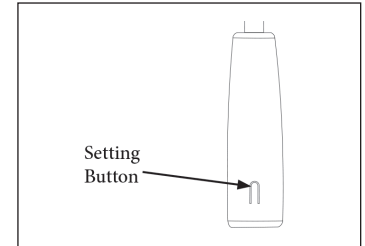

4. Press the SETTING button until the shade makes one beep. (This locks in the lower limit.)

ADJUSTING UPPER LIMIT

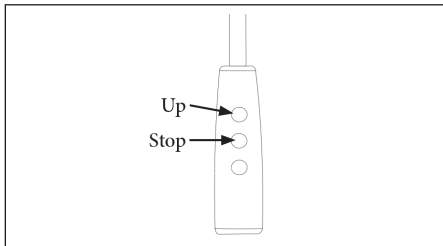

1. Use the UP button to raise the shade. Press STOP when the shade is near the desired upper limit.

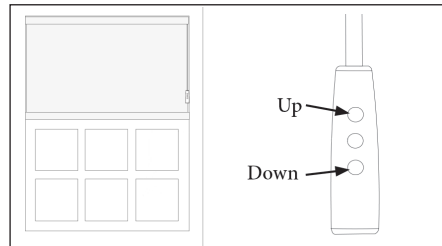

2. Use the UP and DOWN buttons to adjust the upper limit more accurately.

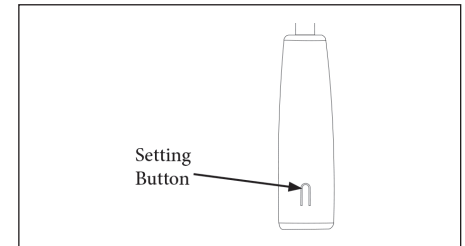

3. Press the SETTING button until the shade makes one beep. (This locks in the upper limit.)